

Deploy to System Integration Testing (SIT) Environment

Deploying on SIT allows developers and testers to assess the Aras Innovator's behavior and performance in a simulated production-like setting before it is deployed to the actual production environment.

The following steps outline the process of deploying Aras Innovator to SIT:

1. Navigate to <https://dev.azure.com/{organization}/{project}>.
2. Identify the Build to deploy.
3. Select the **DeployToSIT** pipeline and click **Run Pipeline**.

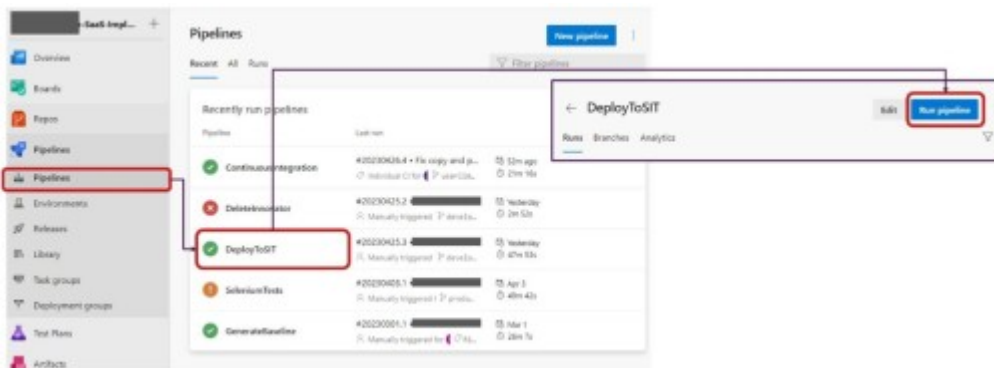

4. Select the **Branch** in the Work Repo and click **Resources**.

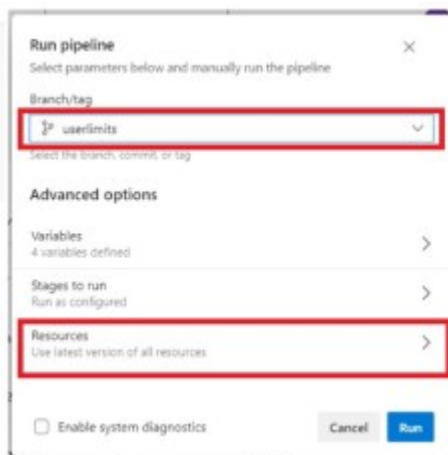

5. Click **ContinuousIntegration** (last successful **Run**) and select the required **Run**.



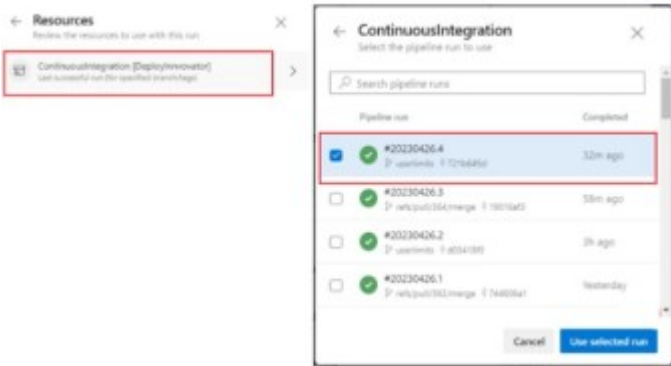

6. Click the **Use selected run** button.
7. Navigate back to **Run Pipeline** dialog box and click **Run**.



8. Optionally, click the **Deploy** link to watch the progress.
9. When the **Pipeline** is completed, a link to the new instance should be available on the **Wiki** page for testing.

10. **Important**

If a pipeline run is going to be deployed to production, UAT, or staging, you also need to retain it—along with the source CI pipeline run (see the “Pipeline retention policy” section). To do this, open the pipeline run and click **Retain** in the menu.



