

# Measuring CAD Models

The **Measure** button on the **Standard Viewing** toolbar provides access to the separate **Measure** toolbar with options for measuring the geometrical parameters of a given 3D CAD model.



With the **Measure** toolbar, end users can perform the following measurements of a CAD model:

## Important

Note: Measurements are displayed in the CAD model authored units.

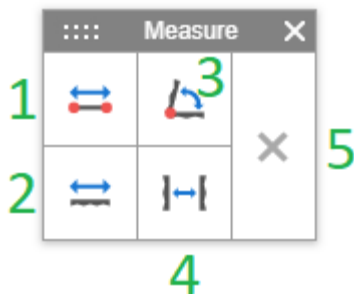

1. **Measure Point to Point:** a distance between two arbitrary points.

Click this button and then click twice on a model to set these points.

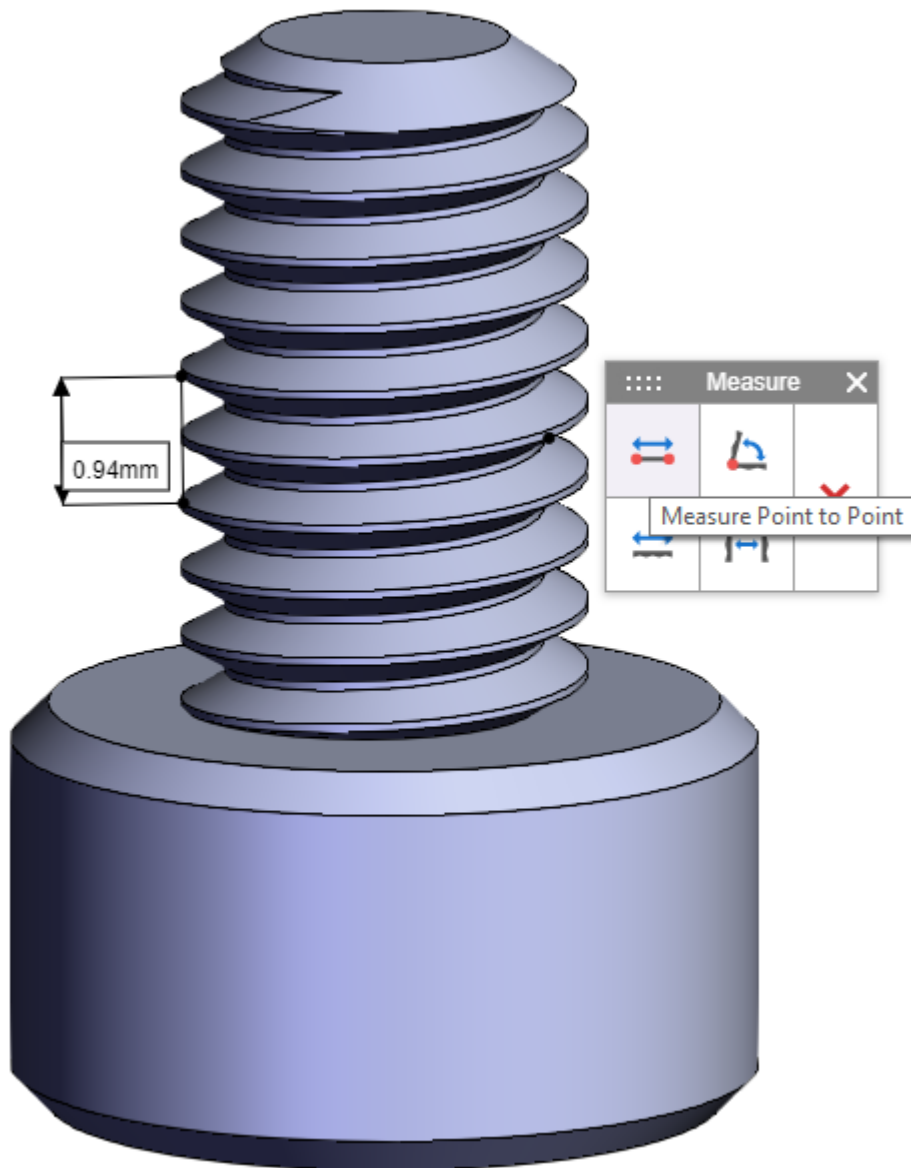

2. **Measure Edges**: a length or radius of an arbitrary edge depending on the edge type.

Click this button and then click an edge. The measured edges are bold.

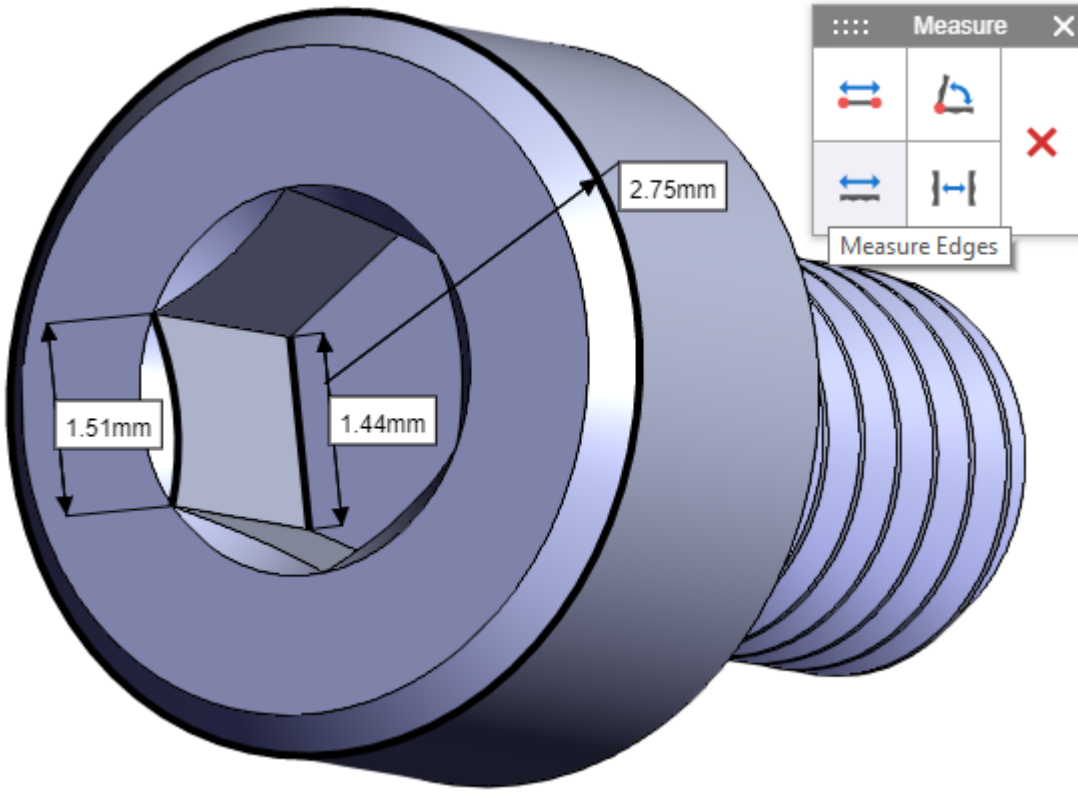

3. **Measure Angle Between Faces:** an angle in grades between two arbitrary surfaces.

Click this button and then click two appropriate surfaces.



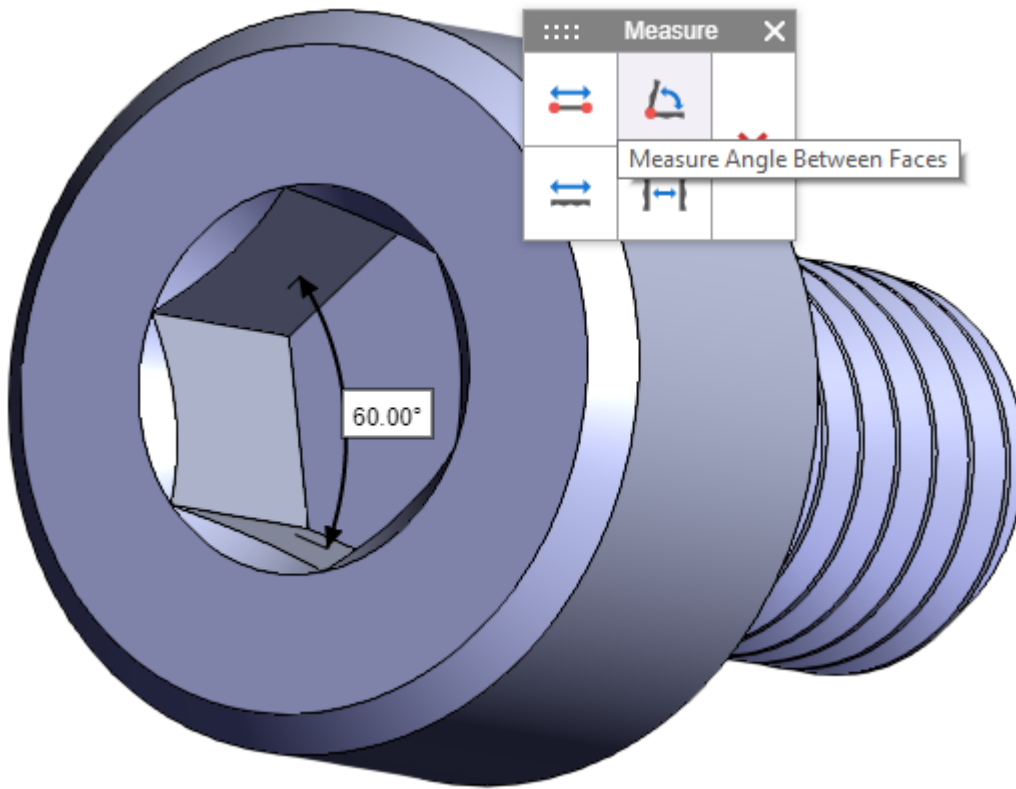

4. **Measure Distance Between Faces:** a distance between two arbitrary surfaces.

Click this button and then click two appropriate surfaces.

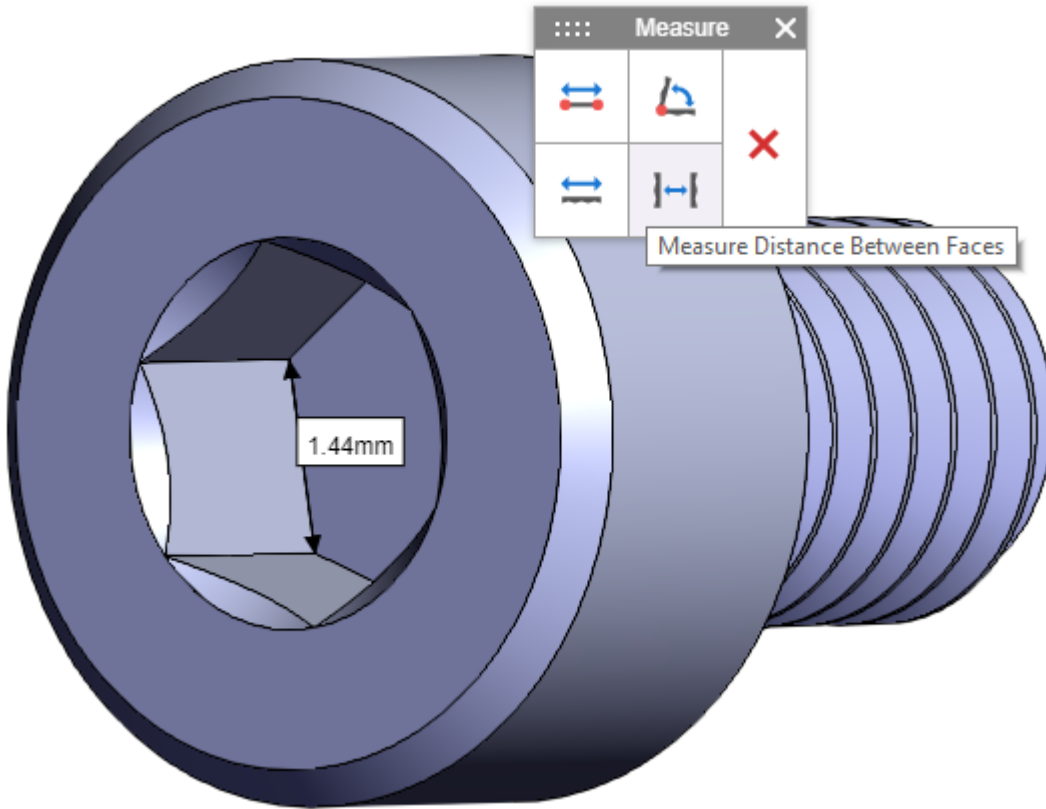

5. Click **Delete All** to clear a model from all measurements.

