

Putting Labels on CAD Models

The **Label** button on the **Basic Markup** or **Standard Markup** toolbar provides access to the label feature.

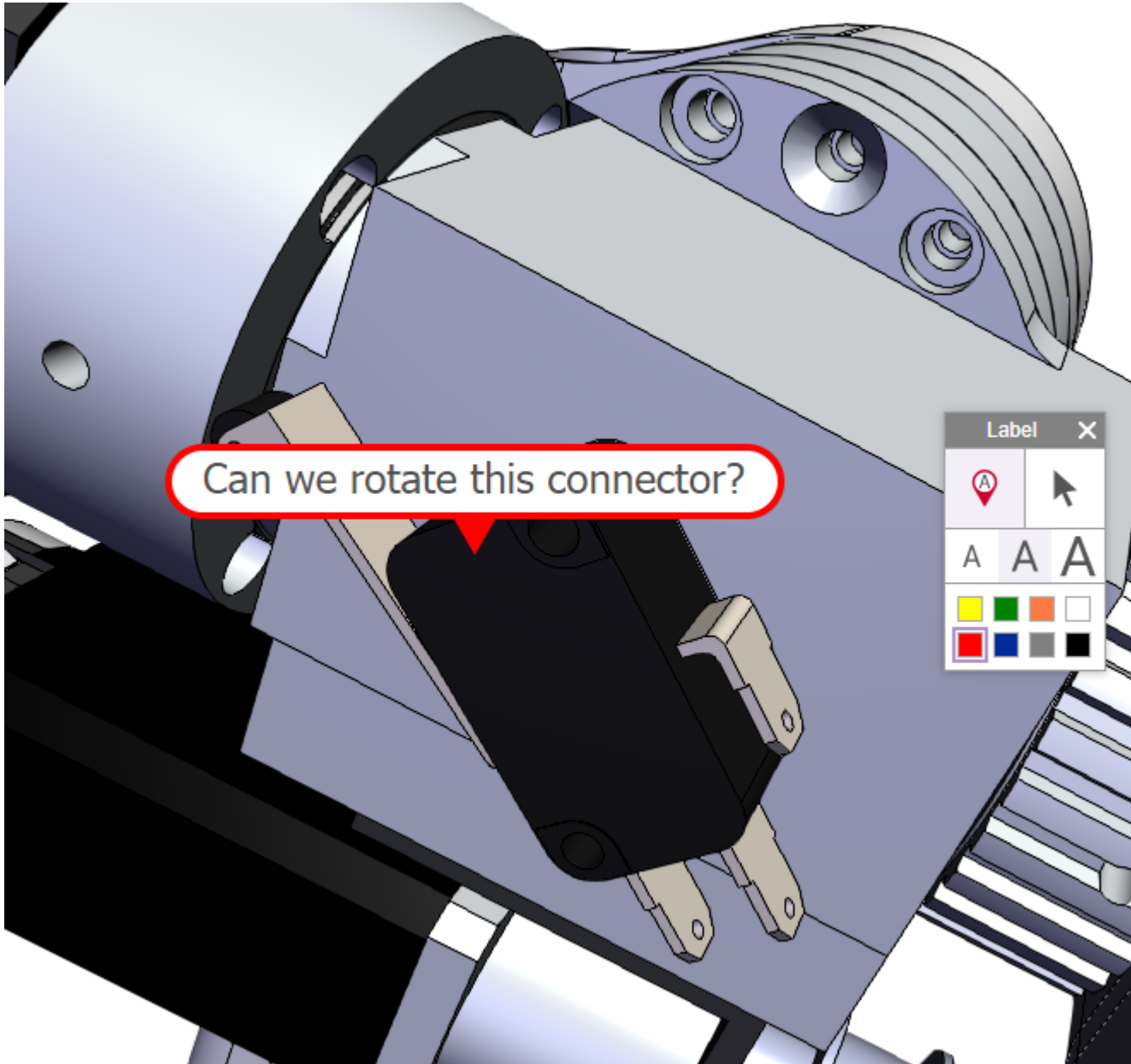

With the discussed feature, an end user can put arbitrary labels with comments on a 3D CAD model.



Depending on a given toolbar, the feature is displayed as follows:

- **Basic Markup:** as the separate **Label** toolbar.

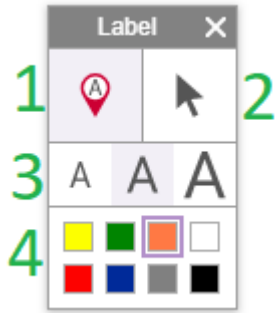

- **Standard Markup:** as **additional** buttons on this toolbar.



The label feature provides the following functionality:

1. **Label:** to add labels to a 3D CAD model.
2. **Select:** to select markups on a 3D CAD model.
3. **Font sizes:** to set the size of a text to be written in a new label.
4. **Label colors:** to set the color of a label to be added.

To use a feature or option, a user should click the required button.

The following steps outline the process to create a label:

1. Click the **Label** button.
2. Click on a 3D CAD model where the label should be put.



3. Enter the appropriate text inside the label.

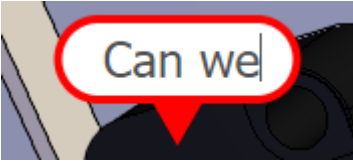

4. Click the **Select** button.
5. To select a label, a user should click **Select** and then select this label. A selected label has blue edges with a circle at the bottom point and can be repositioned.

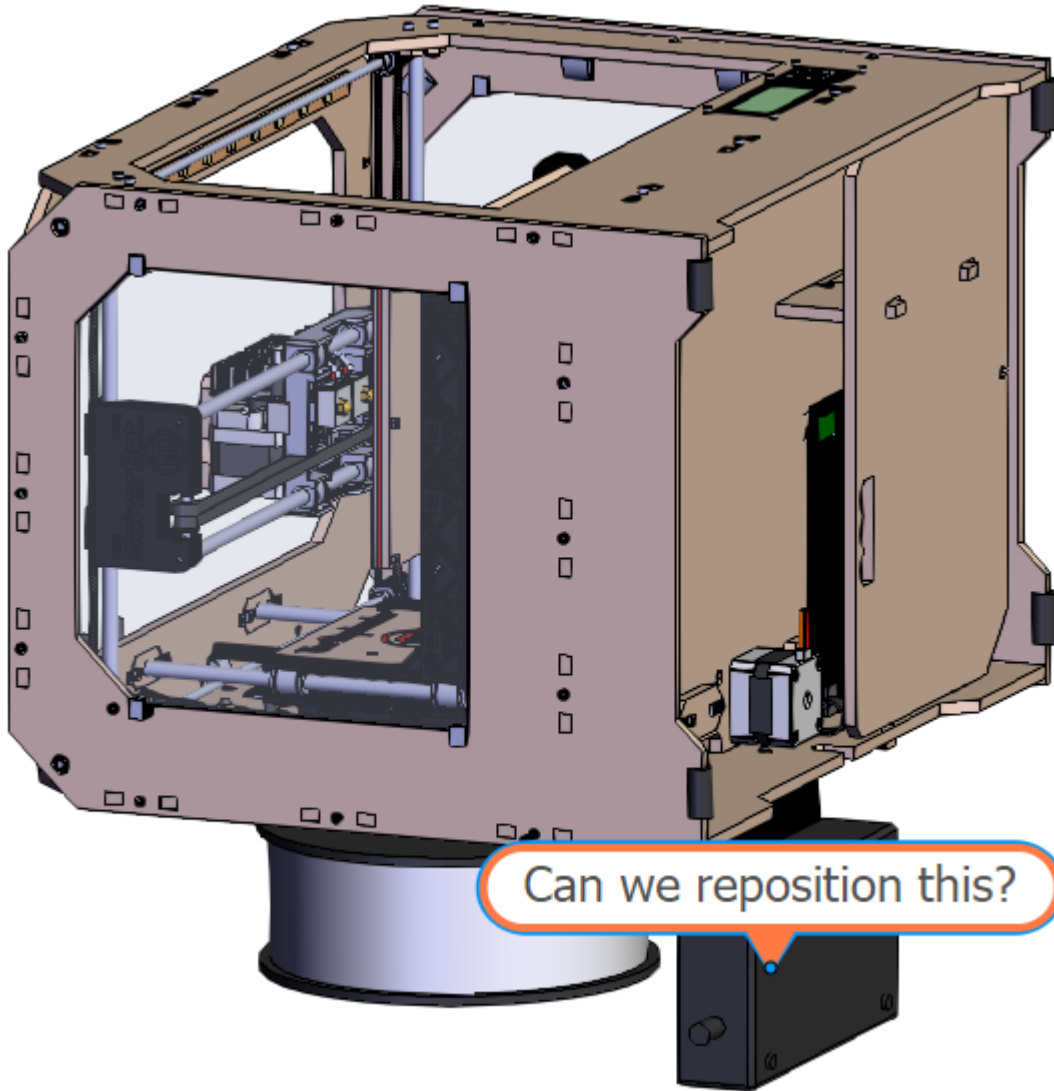

6. To move an existing label to a new position, a user should select this label and drag its colored frame below the text box and above the blue bottom circle.



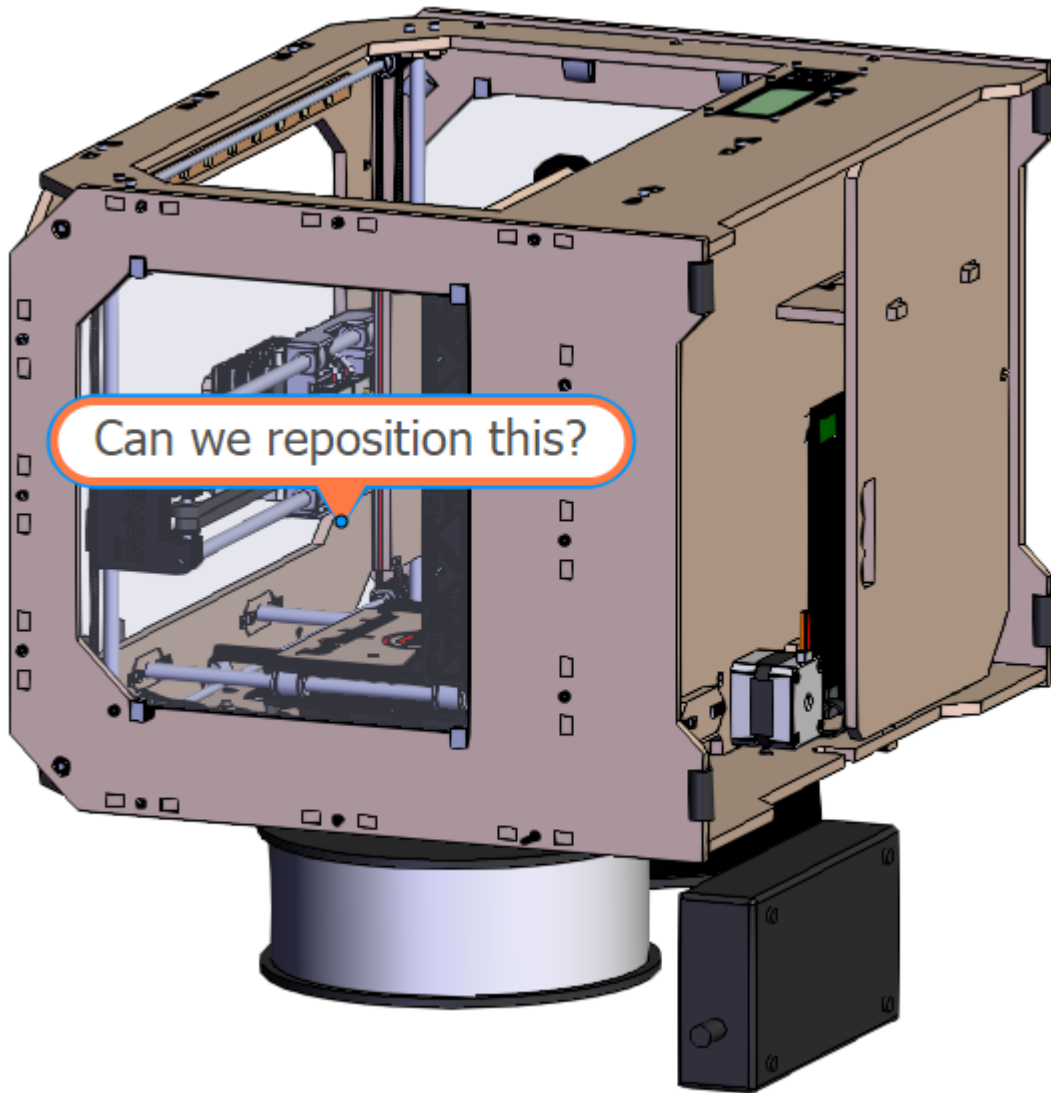

7. To change where a label points to, a user should select this label and drag its blue bottom circle.

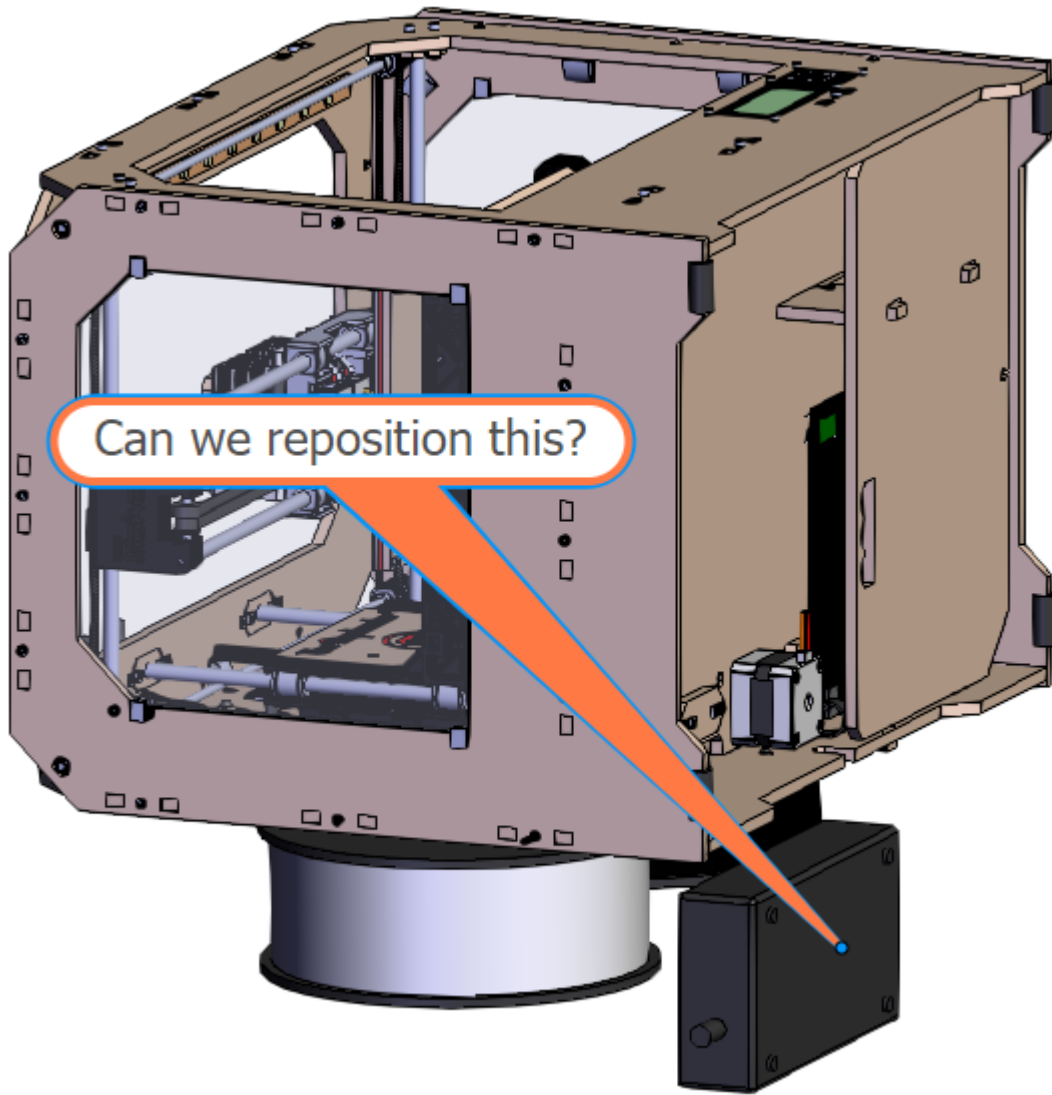

8. To change the label text, a user should click inside the label and edit the text.

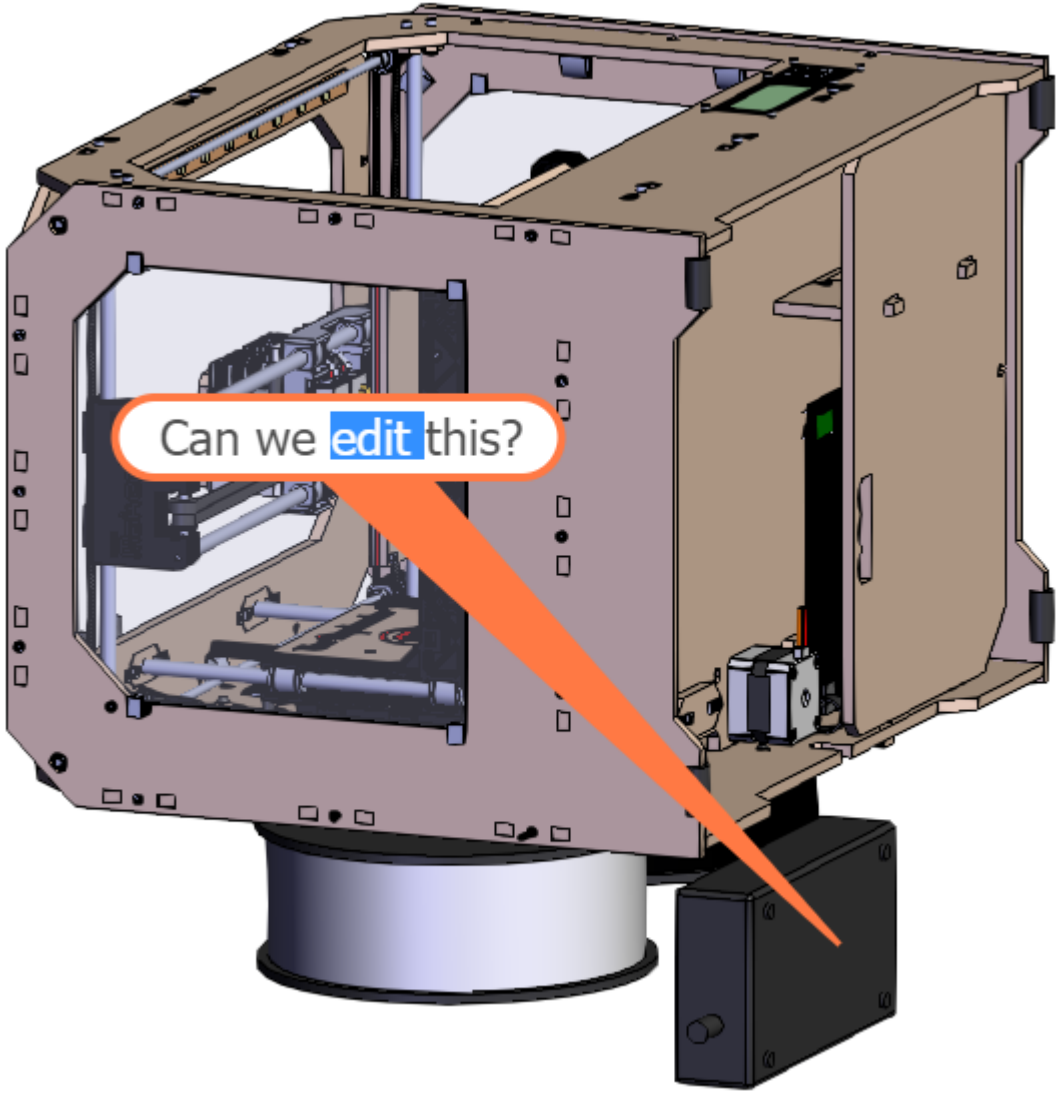

Can we edit this?

