

# Adding Markup Lines by Center

The following steps outline the process to draw a markup line between the centers of two arbitrary edges on one or more 3D CAD models:

1. Right-click anywhere on the 3D scene.
2. Click **Markup Line by Center**.

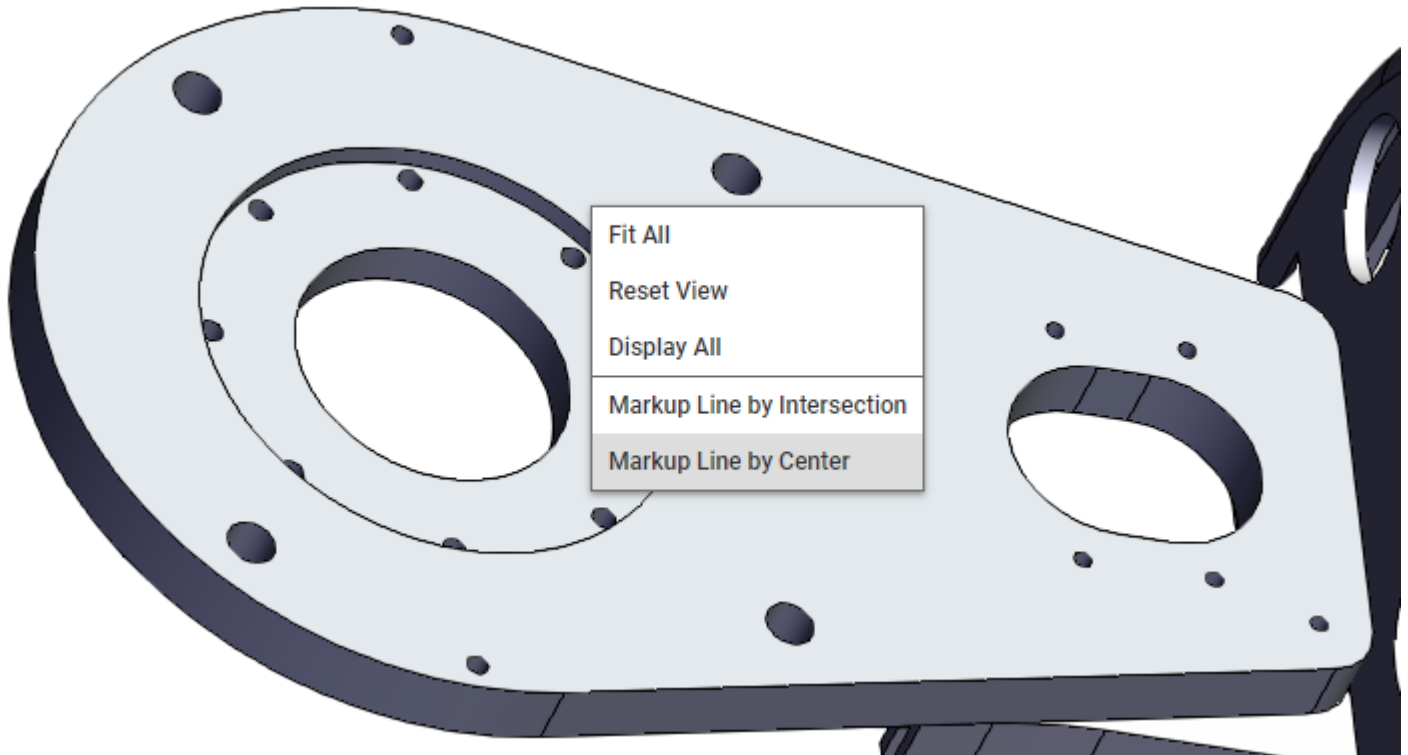

3. Click on the first edge.

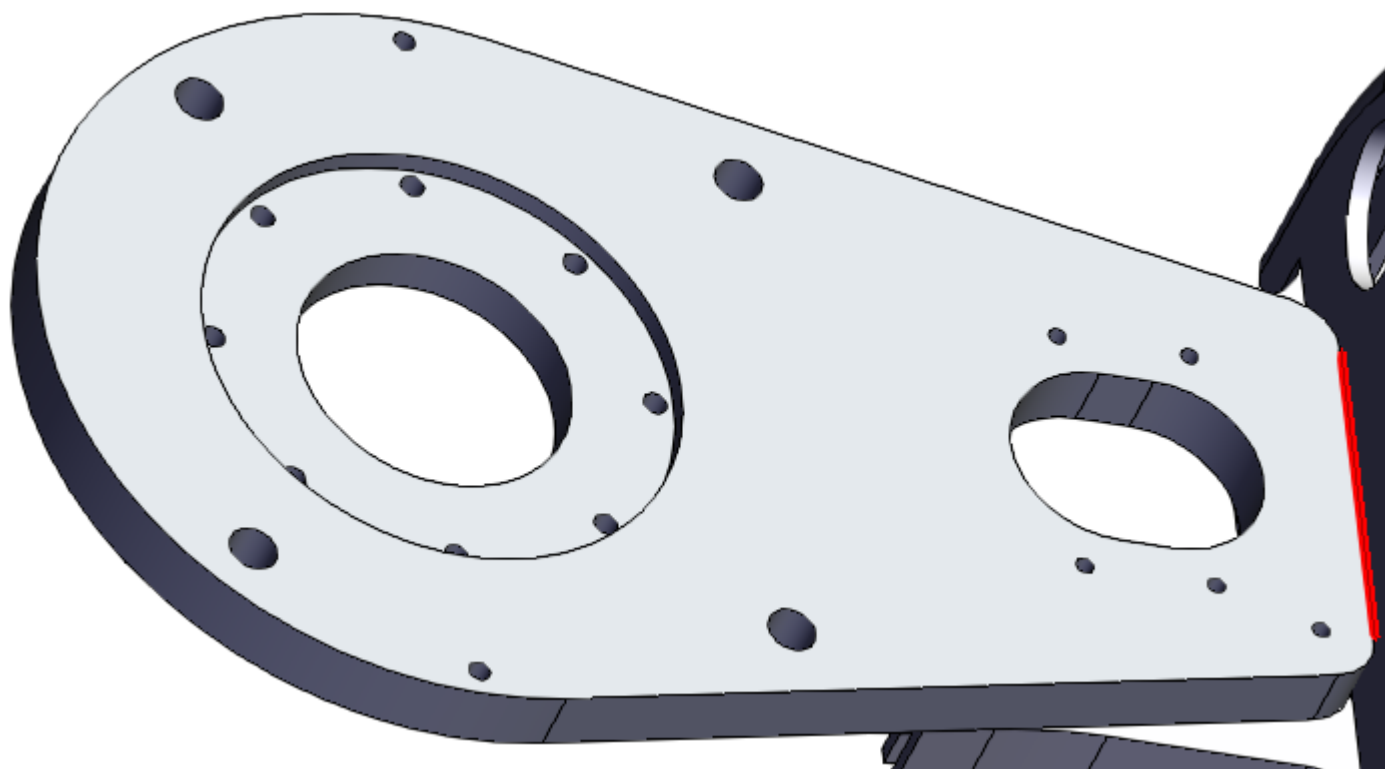

**Important**

Edges available for selection are highlighted with red while hovering over them.



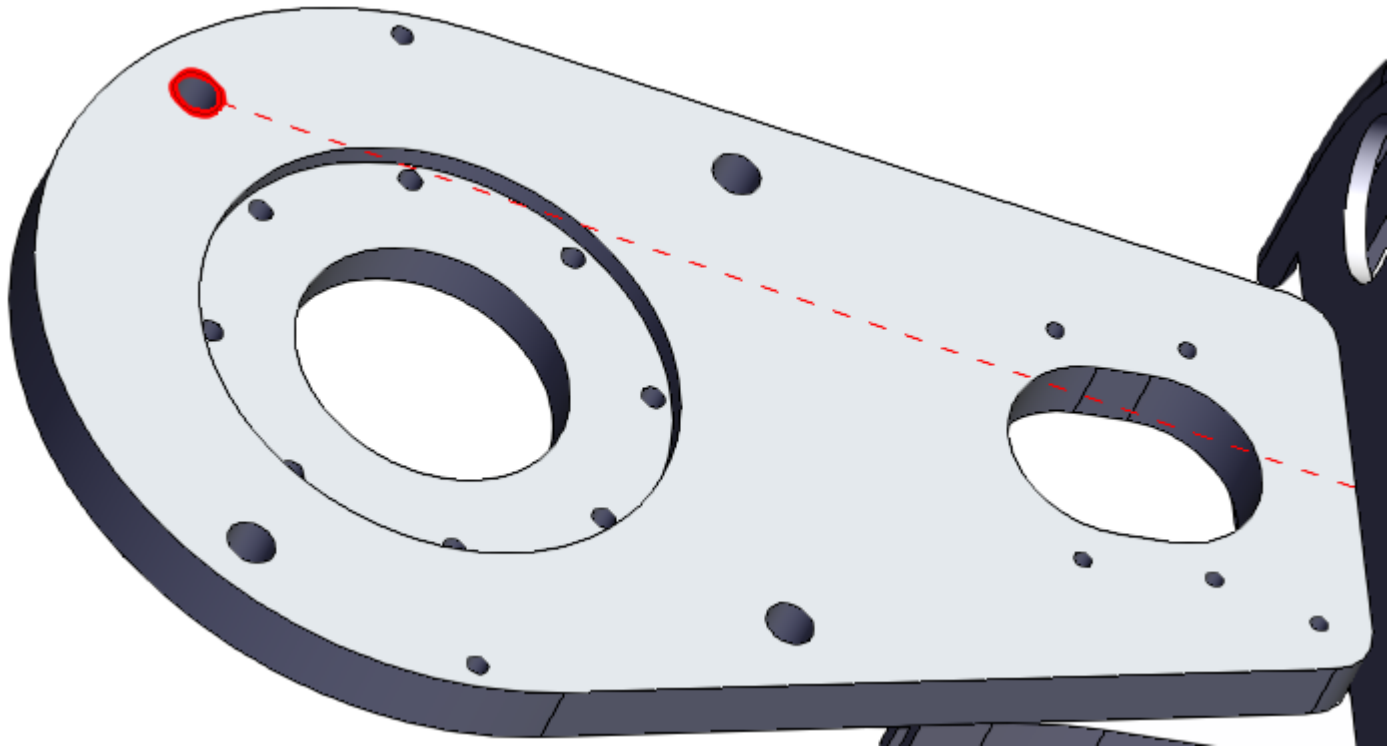

4. Click on the second edge. The markup line between the centers of the two edges is created.

